

INSTALLATION INSTRUCTIONS

DESCRIPTION: Soft Side Cover Kit

PART NUMBER: 2PG-F17J0-V0

MODEL: Viking VI



⚠ WARNING

Please read and understand these instructions completely before installation to avoid possible injury, or damage to the accessory or vehicle.

- This weather enclosure is not intended to prevent injury during collisions or rollovers.
- Always wear a seat belt and a helmet when riding in this vehicle

NOTICE:

- This installation requires a torque wrench and a pop rivet gun and should be performed by an authorized Yamaha dealer or other qualified technician.
- Do not tow the vehicle on an open trailer with this accessory installed, as the accessory is not designed for use at highway speeds.

WARRANTY INFORMATION:

Genuine Yamaha Accessories are covered by a one-year limited warranty against defects in material or workmanship. Labor for replacement of defective components is not covered. See your Yamaha dealer for a copy of the warranty statement.

DEALER OR INSTALLER:

These instructions contain important information for future reference and *must* be given to the customer.

COMPONENTS NOT INCLUDED IN THIS KIT:

Folding Windshield Kit (p/n: 1XD-F83J0-V0-00), Rear Window Kit (p/n: 2PG-K750A-T0-00 or 2PG-K750A-V0-00), Hard Top Kit (p/n: 1XD-K84A0-V0-00), Soft Top Kit (p/n: 1XD-K830V-T0-00 or 1XD-K830V-V0-00)

PARTS LIST:

No.	Part Number	Description	Qty
--	2PG-F17J0-V0	Soft Side Cover Kit	--
①	*	Left Side Cover	1
②	*	Right Side Cover	1
③	*	Windshield Seal	1
④	*	Windshield Seal Mount Strip	1
⑤	*	3mm Rivet Nut	2
⑥	*	Rivet	42
⑦	*	Snap	42
⑧	*	M6 Bolt	6
⑨	*	M6 Nylock Nut	6
⑩	*	M6 Washer	6
⑪	**	Snap Stick	1

* Part supplied with kit only and not available separately. **Part not shown and not sold separately by Yamaha

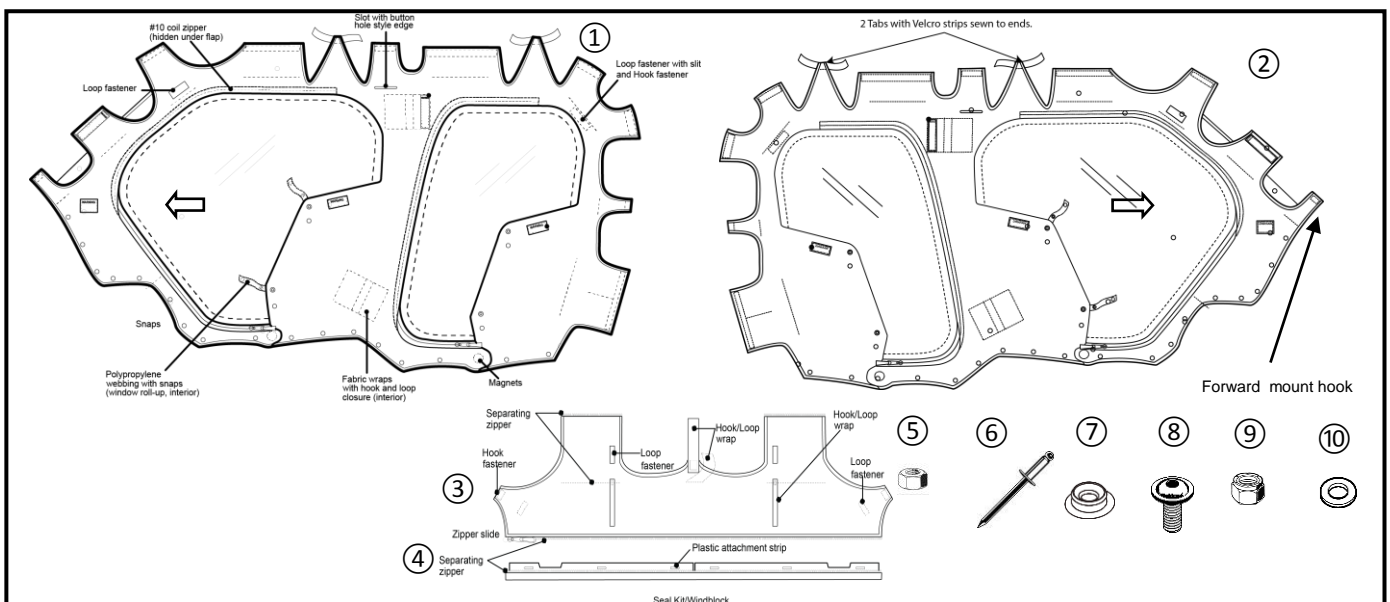

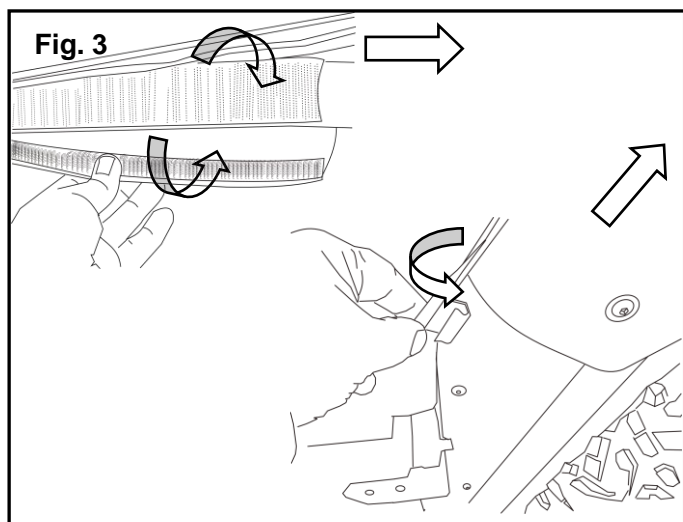
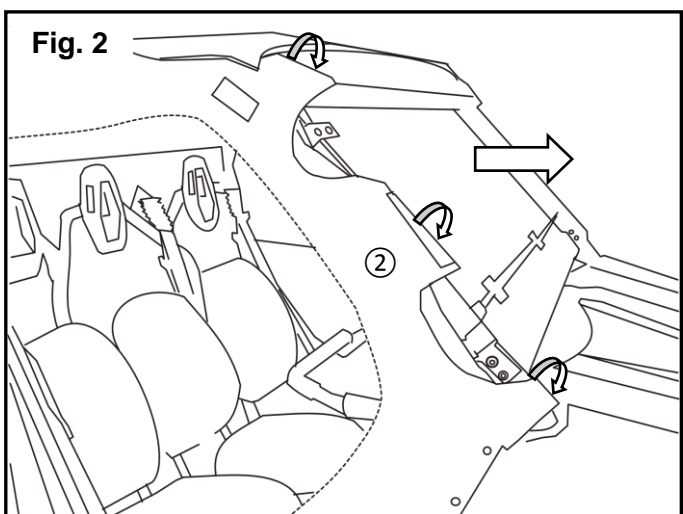
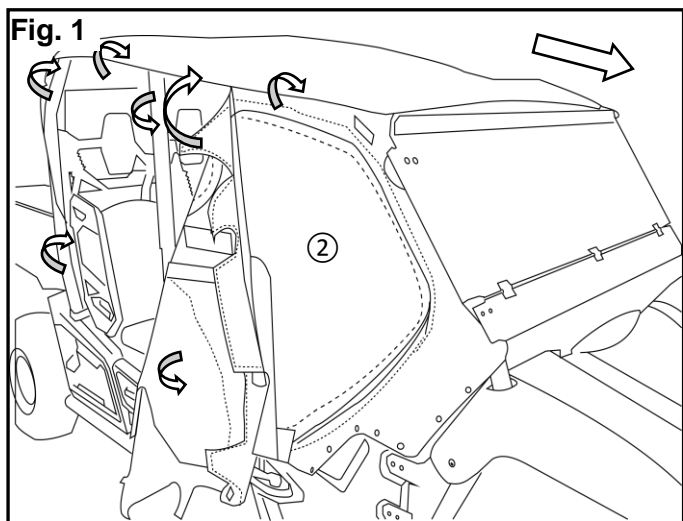

PREPARATION:

- Place the vehicle on a secure and level surface.
- Set the parking brake.
- Clean the mount surfaces before starting installation.
- Apply Snap Stik® to all snaps before installation.

INSTALLATION:

1. Starting at the right rear unscrew the two mount bolts that hold the roof clamp to the overhead bars. Flip the clamp 180 degrees so that the clamp opens as shown in Fig. 11.
2. Continuing on right side of the vehicle, drape the Right Side Cover ① over the roof tubes, passing the 'tabs' on the cover between the top and the roof tubes. Start in the middle of the cab as shown in Fig. 1 and wrap the hook and loop tabs around the tube and secure.
3. In the front of the cab, wrap 3 tabs around the roof tube as shown in Fig. 2. In the rear of the cab, wrap 4 tabs around the roof tubes (not shown).
4. Secure the forward mount hook inside the channel as shown in Fig. 3.
5. Ensure the tabs are wrapped around the roof tubes and secured to the loop side as shown in Fig. 3. Seal all 10 mounting tabs around the roof tubes.
6. Ensure the Right Side Cover ① is centered on the tube frame and is hanging evenly front and rear.
7. 2 tabs have hook and loop straps sewn on to the end (Fig. 4). **Note:** These 2 tabs pass under the overhead bars and do not wrap over the top. Fig. 4 shows how the hook and loop straps sewn to the ends of the tabs wrap around the cross tubes.
8. Adjust the side cover to minimize wrinkles and folds. Ensure all 10 tabs are secured to hook and

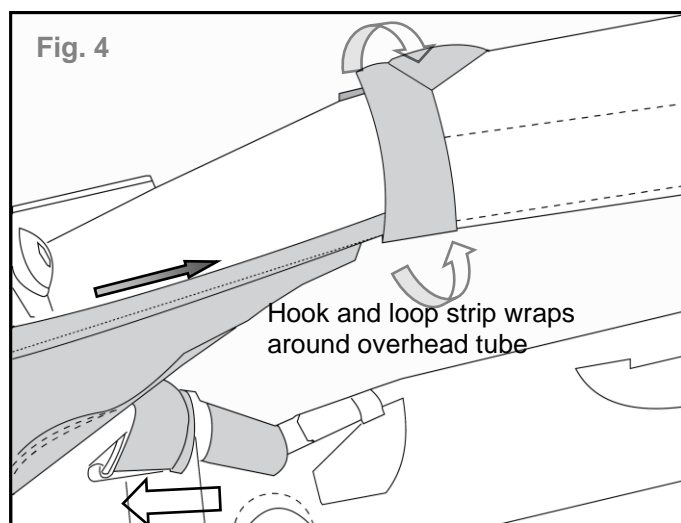

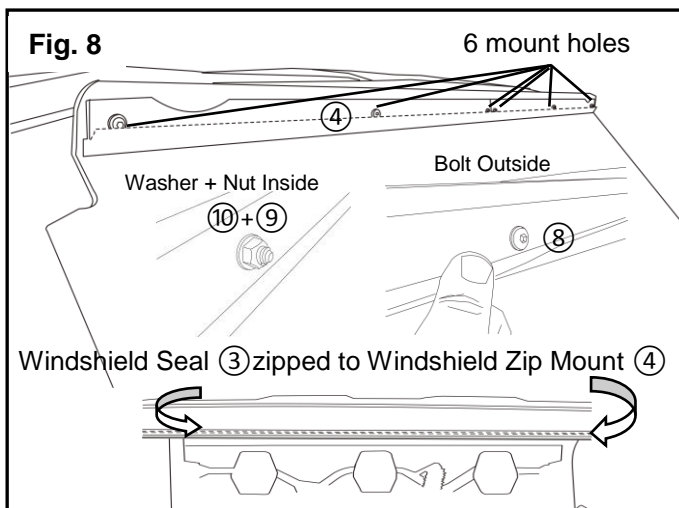
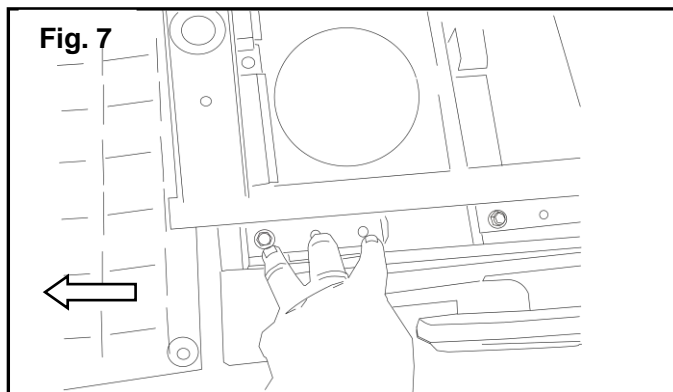
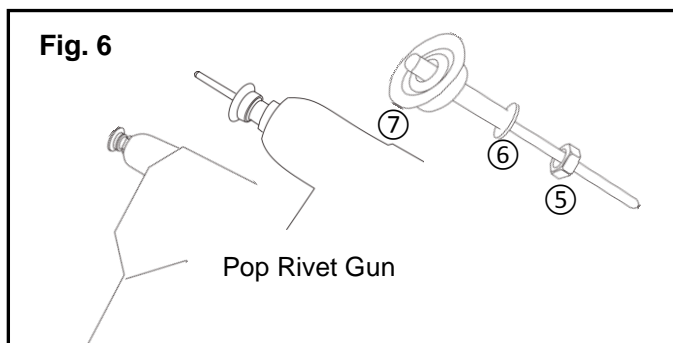
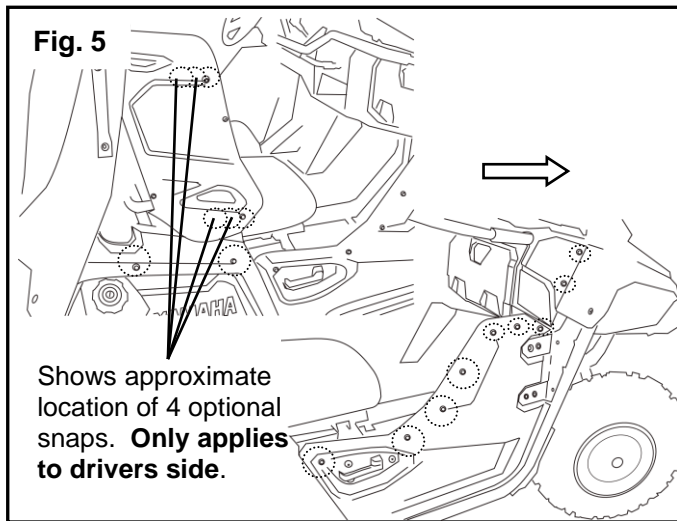

loop pads.

9. Without putting tension on the side cover, mark the locations of each of the 13 snaps on the vehicle panels as shown in Fig. 5.
10. Drill out the snap mount holes with a 3mm drill. Use a tape mark on the drill bit to set the drill depth at 25mm.
11. Use a pop rivet tool (not included in this kit) to install the Snaps (7) on the right side of the vehicle. Fig. 6 shows the configuration. Here are the snap installation steps:
 - Insert Rivet (6) into Snap (7),
 - place 3mm Rivet Nut (5) on Rivet (6).
 - Put Rivet (6) into pop rivet tool, and
 - insert Rivet into body with tool.
 - Pull the handle on the pop rivet tool to close the Rivet (6) and complete the installation of the Snap (7).
12. Repeat steps 1 through 11 on the Left side.
13. **Optional Installation Step:** If the driver's seat will not be moved forward or back, skip this step.

The side bolster is attached to the seat frame. The snap points for the side cover change when the driver's seat is moved. See Fig. 7 for a top view of the 3 driver's seat adjustment positions.

Start with the driver's seat in the rear most position. The side cover and all snaps should already be installed. Move the driver's seat up a position. Mark the side bolster for 2 additional Snaps (7) (shown in Fig. 5). Then move the seat up to the third position. Mark the side bolster for 2 more snaps. Drill the holes and install the Snaps (7) following the process in steps 9 and 10. Extra rivets and snaps are provided for the 4 additional snaps installed in this optional step.

14. If the folding windshield is installed, remove it and do this step on a work bench.

⚠WARNING

Take care to protect the surface of the windshield from being scratched or damaged.

Lay the Windshield Seal Mount Strip (4) along the top edge of the outside surface of the windshield. Center the strip side to side and between the top of the screen and the first bend as shown in Fig. 8.

15. Mark the locations of the 6 openings in the Windshield Seal Mount Strip (4). Use a 7mm drill bit to drill out the mount holes.

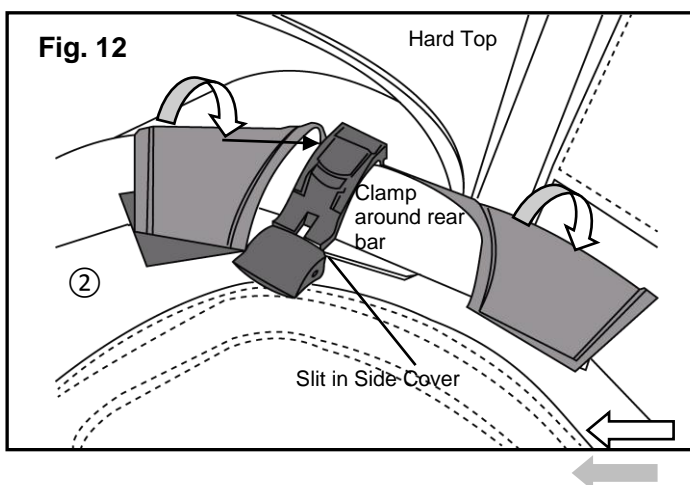
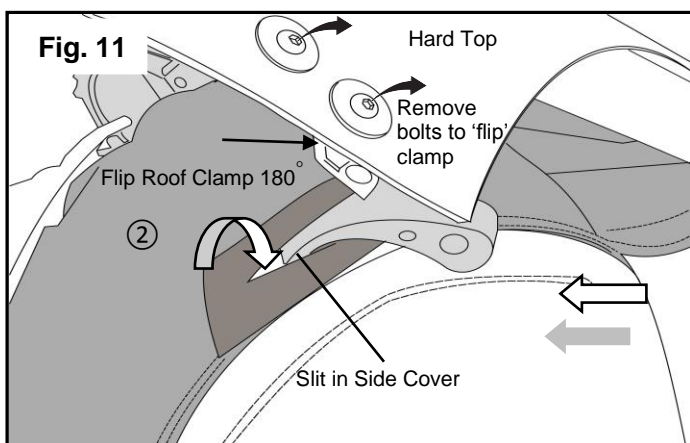
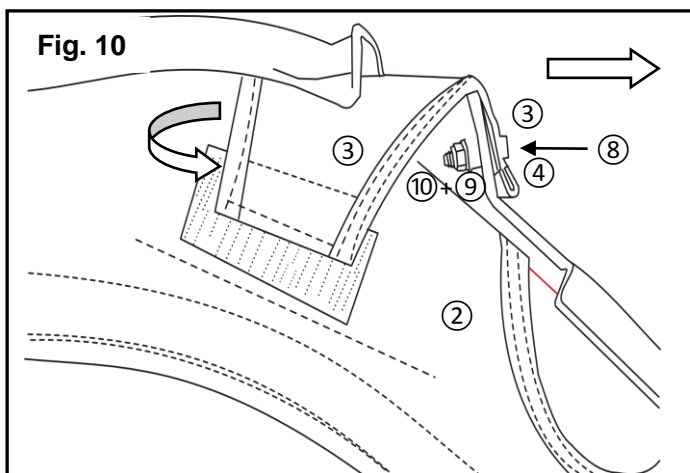
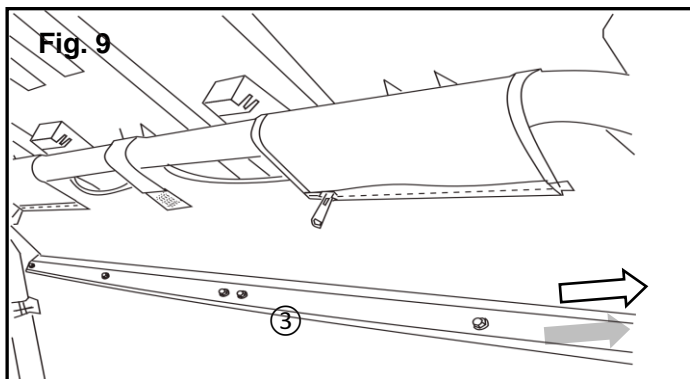

16. From the outside of the windshield, install the Windshield Seal Mount Strip (4) to the windshield. Install M6 Bolts (8) through the holes. See Fig. 8.
17. Working from the inside of the windshield, install M6 washers (10) and M6 Nylock Nuts (9) to the bolts and torque to 2.7 Nm (0.28 m-kgf, 2 ft-lbf). See Fig. 8.
18. Install the folding windshield to the Vehicle.
19. Zip the Windshield Seal (3) to the Windshield Seal Mount Strip (4), right to left. See Fig. 8.
20. Working with the Windshield Seal (3), feed the securing tabs through the space between the top and the roof tube frame. Wrap the two zip tabs around the tube and zip. Wrap the hook and loop strap around the tube and press to secure as shown in Fig. 9.
21. Feed tabs on right and left side of the windshield under the top and press the 'loop' patch to secure as shown in Fig. 10.

Note: Additional steps for hard top installs:

22. The hard top is secured to the roof tubes with clamps. The side covers have a slit at the rear upper right and rear upper left. These slits are covered by a hook and loop patch. Remove the hook and loop patch.
23. Release the rear most clamps on either side of the hard top (2 clamps).
24. Remove the 2 bolts that secure each clamp to the roof. Flip the roof clamps 180 degrees and reuse the bolts to reinstall the roof clamps to the hard top. See Fig. 11.
25. Working from the outside, open the clamps and pass the clamp handles through the slits (Fig. 11).
26. Working from the inside, clamp the hard top to the roof tube by closing and locking the 2 clamps (Fig. 12).

MAINTENANCE:

Periodically, check all hardware and straps. If loose hardware is found, re-torque or re-tighten. If zippers or snaps become hard to operate, apply Shurhold Snap Stick™ to lubricate snaps and zippers.

CARE AND CLEANING:

Use a clean soft cloth and mild detergent with warm water to clean top. Rinse and dry. Use Yamaha Windshield & Visor Plastic Cleaner & Conditioner (p/n ACC-PLASP-OL-11) to clean the plastic windshield and windows.

CUSTOMER SERVICE:

For further information see your Yamaha dealer.

ESTIMATED TIME TO INSTALL: 0.5 HR